



AVK GATE VALVE, FLANGED, AWWA, PN10/16

45/56-001

Brass/alu-bronze stem, OS&Y, handwheel, EPDM (NBR gasket), A4 bolts, brass wedge nut, 250 µm red EP, UL/ULC/FM

AVK series 45 gate valves are designed to US-standards. Valve body, bonnet and wedge core are made of ductile iron which ensures high strength and reliability. The wedge is fully vulcanized with AVK's own drinking water approved EPDM rubber compound featuring an outstanding ability to regain its original shape. Corrosion protection is excellent with all iron parts coated with fusion bonded epoxy, fasteners in stainless steel and stem in either copper alloy or stainless steel.

Product description:

Flanged gate valve with rising stem OS&Y for fire protection applications to max. 70°C/160°F, rated working pressure DN 50-300: 250psi/17bar, DN 350-400: 200psi/14bar

Design standards:

- AWWA C509, FM 1120/1130, UL 262
- Face-to-face dimension according to ANSI B16.10
- Flange drilling to EN1092, PN10/16

Test/Approvals:

- Hydraulic tests according to FM and UL Standards
- Seat: 1.5 x PN (in Bar). Body: 2 x PN (in Bar). Closing torque test.
- FM Approved, UL listed

Features:

- Fixed, integral wedge nut prevents vibration and ensures durability
- Wedge fully vulcanized with drinking water approved EPDM rubber and equipped with wedge shoes to provide smooth operation
- Large conical stem hole in the wedge prevents stagnant water
- Wedge and body guide rails ensure stable operation
- Stainless steel stem with rolled threads for high strength
- Full circle thrust collar provides fixation of the stem and low free running torques
- Triple safety stem sealing with an NBR wiper ring, a polyamide bearing with four NBR O-rings, and an EPDM rubber manchette
- Round EPDM bonnet gasket fixed in a recess
- Countersunk and sealed stainless steel bonnet bolts encircled by the bonnet gasket
- Full bore
- Low operating torque
- Fusion bonded epoxy coating in compliance with DIN 3476 part 1 and EN 14901

Accessories:

Supervisory switch



Expect... **AVK**

The designs, materials and specifications shown are subject to change without notice due to the continuous development of our product range.

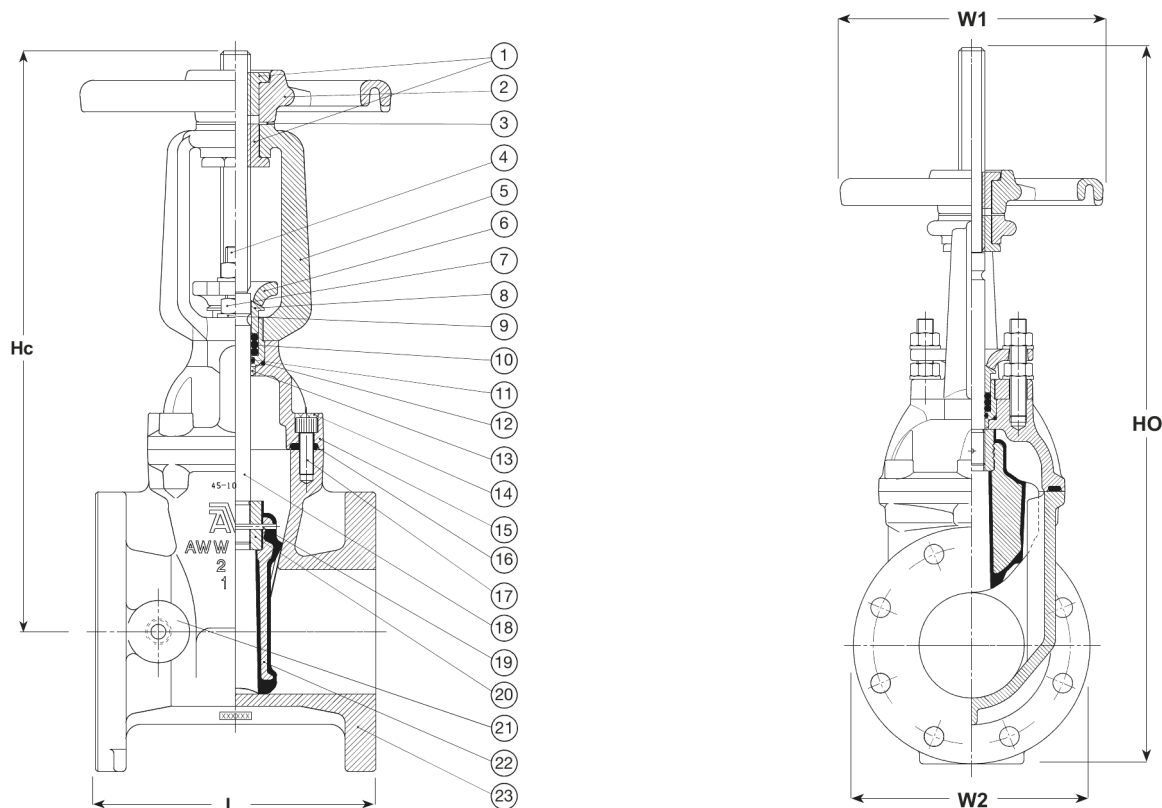
AVK GATE VALVE, FLANGED, AWWA, PN10/16**45/56-001****Brass/alu-bronze stem, OS&Y, handwheel, EPDM (NBR gasket), A4 bolts, brass wedge nut, 250 µm red EP, UL/ULC/FM****Component list:**

1. Stem nut	Brass CW724R Si-alloy	13. Bushing	Polyamide
2. Handwheel	Cast iron	14. Bonnet bolt seal	Hot melt glue
3. Thrust washer	Gunmetal bronze	15. Bonnet	Ductile Iron
4. Stud bolt	Stainless steel A4	16. Bonnet gasket	NBR rubber
5. Yoke	Ductile Iron	17. Bonnet bolt	Stainless steel A4
6. Gland follower	Ductile Iron	18. Stem ⁽¹⁾	Copper alloy
7. Nut	Stainless steel A4	19. Pin	Stainless steel A2
8. Gland	Polyamide	20. Wedge nut	Brass DZR CW626N
9. Washer	Stainless steel A4	21. Boss	Ductile iron, EPDM encapsulated
10. Stem seal O-ring	SBR rubber	22. Wedge	Ductile iron, EPDM encapsulated
11. O-ring	NBR rubber	23. Body	Ductile iron GJS-500-7 (GGG-50)
12. O-ring	NBR rubber		

Components may be substituted with equivalent or higher class materials without prior notification.

1) DN300-400: Alu-bronze C63020

Reference nos. and dimensions:

AVK ref. no.	DN mm	Flange drilling	L mm	H closed mm	H open mm	W1 mm	W2 mm	Turns to open	Theoretical weight/kg
45-050-56-01614020	50	PN10/16	169	400	450	180	165	14	19
45-065-56-01614020	65	PN10/16	190	380	450	180	178	18	23
45-080-56-01614020	80	PN10/16	203	395	478	180	191	20	25
45-100-56-01614020	100	PN10/16	229	473	575	254	229	21	39
45-150-56-01614020	150	PN10/16	267	635	787	305	280	30	63
45-200-56-00614020	200	PN10	292	787	991	356	343	35	97
45-200-56-01614020	200	PN16	292	787	991	356	343	35	97
45-250-56-006B4020	250	PN10	330	935	1189	432	406	44	158
45-250-56-016B4020	250	PN16	330	935	1189	432	406	44	158
45-300-5C-006B4020 ⁽¹⁾	300	PN10	356	1054	1359	432	483	44	239

The designs, materials and specifications shown are subject to change without notice due to the continuous development of our product range.

AVK GATE VALVE, FLANGED, AWWA, PN10/16**45/56-001****Brass/alu-bronze stem, OS&Y, handwheel, EPDM (NBR gasket), A4 bolts, brass wedge nut, 250 µm red EP, UL/ULC/FM****Reference nos. and dimensions:**

AVK ref. no.	DN mm	Flange drilling	L mm	H closed mm	H open mm	W1 mm	W2 mm	Turns to open	Theoretical weight/kg
45-300-5C-016B4020 ⁽¹⁾	300	PN16	356	1054	1359	432	483	44	239
45-350-5C-01614020 ⁽¹⁾	350	PN16	381	1384	1795	640	533	58	305
45-350-5C-016B4020 ⁽¹⁾	350	PN16	381	1384	1795	640	533	58	290
45-400-5C-006B4020 ⁽¹⁾	400	PN10	406	1385	2113	640	597	62	310
45-400-5C-01614020 ⁽¹⁾	400	PN16	406	1398	1823	640	597	62	310
45-400-5C-016B4020 ⁽¹⁾	400	PN16	406	1385	2113	640	597	62	310

⁽¹⁾ Stem in aluminium bronze. 200 PSI/14 bar