



AVK GATE VALVE, FLANGED, PN10/16

55/66-001

EN std., face-face EN558/3, bosses for by-pass, SS stem, A2 bolts, GSK coating

AVK gate valves are designed with built-in safety in every detail. The wedge is fully vulcanized with AVK's own drinking water approved EPDM rubber compound, featuring an outstanding durability due to the ability of the rubber to regain its original shape combined with a double bonding vulcanization process and a sturdy wedge design. A triple stem sealing system, SS stem and the thorough corrosion protection safeguard the unmatched reliability.

Product description:

Flanged gate valve to EN std. for water and other neutral liquids to max. 70°C

Design standards:

- EN 1074 part 1 & 2
- Face-to-face dimension according to EN 558 Table 2 Basic Series 3
- Flange drilling to EN1092, PN10/16

Test/Approvals:

- Seat: 1.1 x PN (in bar), Body: 1.5 x PN (in bar). Operation torque test

Features:

- Wedge nut firmly fixed in the wedge as an integral part to prevent vibration
- Wedge fully vulcanized in drinking water approved EPDM and fitted with wedge shoes that protect the rubber and provide low operating torque
- Stem in stainless steel and brass wedge nut for high corrosion resistance
- A large conical stem hole in the wedge prevents stagnant water from accumulating inside the valve
- Three independent stem seals: outermost a wiper ring protects against the environment, backed up by the two O-rings surrounding the radial bearing and innermost the main hydraulic seal to the flow consists of one or two O-rings
- Thrust bearing consisting of stainless steel discs coated with a low friction, self-lubricating bronze-PTFE composite
- Round bonnet gasket fixed in a recess to avoid blow out
- Counterbored A2-70 stainless steel bonnet bolts encircled by the bonnet gasket and sealed with hot-melt glue
- ISO actuator flange; electric actuator or gearbox is recommended
- Coating in 250 µm blue RAL 5017 fusion bonded epoxy (FBE) to GSK and DIN 3476
- Installation with horizontal or vertical stem
- Bosses for by-pass
- Removable gland flange for replacement of thrust- and radial bearings and seals under pressure

Accessories:

Gearbox, electric actuator and retro-fit by-pass kit

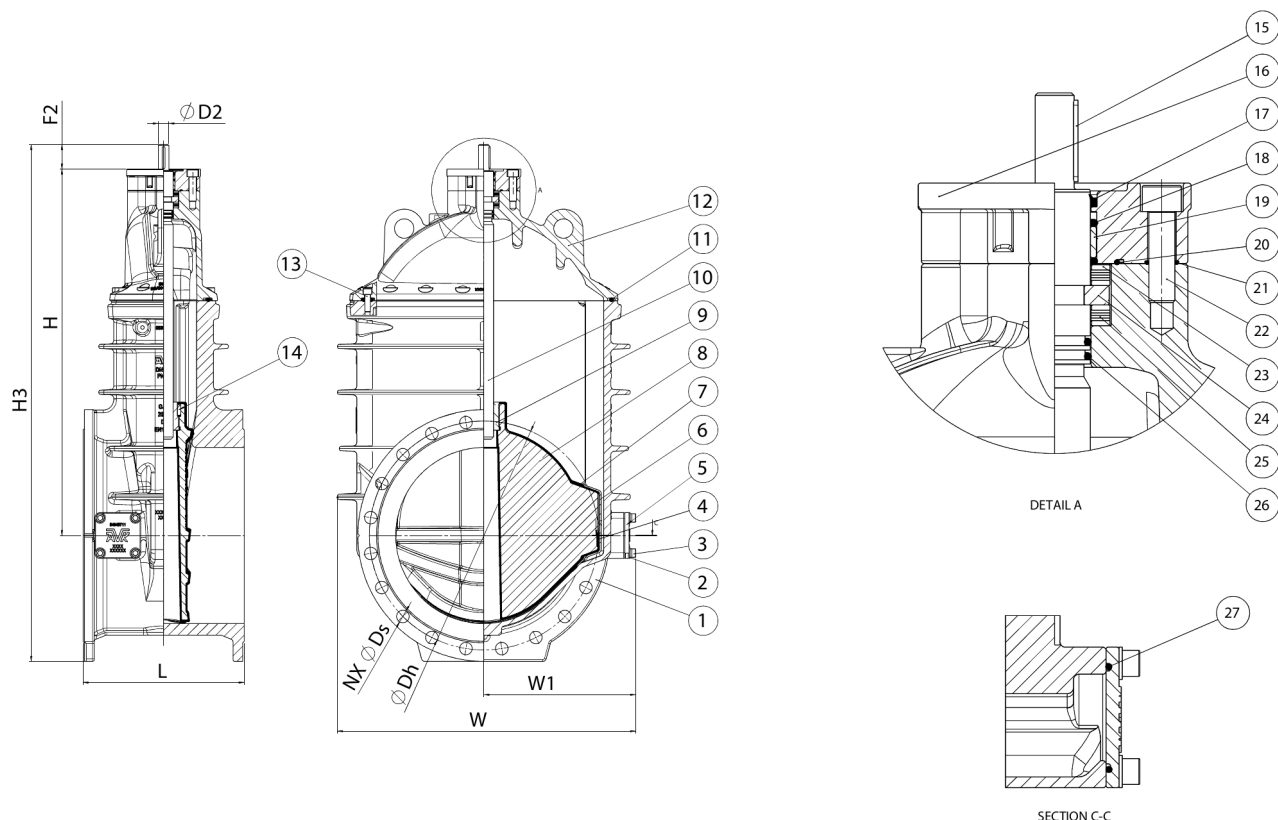

Expect... **AVR**

AVK GATE VALVE, FLANGED, PN10/16**55/66-001****EN std., face-face EN558/3, bosses for by-pass, SS stem, A2 bolts, GSK coating****Component list:**

1. Body	Ductile iron GJS-500-7	15. Key	Stainless steel A2-70
2. Washer	Stainless steel A2-70	16. Gland flange	Ductile iron GJS-500-7
3. Bolt	Stainless steel A2-70	17. Wiper ring	NBR rubber
4. Clip for wedge	Brass CW612N	18. O-ring	EPDM rubber
5. Blind plate	Ductile iron GJS-500-7	19. Bearing shell	PA 6.6
6. Wedge shoe	PA 6.6	20. O-ring	EPDM rubber
7. Wedge rubber	EPDM rubber	21. O-ring	EPDM rubber
8. Wedge core	Ductile iron GJS-500-7	22. Bolt	Stainless steel A2-70
9. Wedge nut	Brass DZR CW724R	23. Thrust washer	Stainless steel 1.4057
10. Stem	Stainless steel 1.4021	24. Thrust collar	Stainless steel 1.4404
11. Bonnet gasket	EPDM rubber	25. Thrust bearing	Stainless steel / PTFE coated
12. Bonnet	Ductile iron GJS-500-7	26. O-ring	EPDM rubber
13. Bolt	Stainless steel A2-70	27. O-ring	EPDM rubber
14. Slotted pin	Stainless steel 1.4404		

Components may be substituted with equivalent or higher class materials without prior notification.

Reference nos. and dimensions:

AVK ref. no.	DN	Flange	L	W	W1	H	H3	F2	D2	Dh	Ds	Number of bolts	Actuator flange	Theoretical weight/kg
mm	mm	drilling	mm	mm	mm	mm	mm	mm	mm	mm	mm			
55-450-66-00464	450	PN10	432	791	396	1016	1393	70	30	565	29.5	20	F16	450
55-450-66-01464	450	PN16	432	807	396	1016	1406	70	30	585	32.5	20	F16	496
55-500-66-00464	500	PN10	457	806	411	1041	1446	70	30	620	29.5	20	F16	467
55-500-66-01464	500	PN16	457	847	431	1041	1468	70	30	650	35.5	20	F16	531
55-600-66-00464	600	PN10	508	926	461	1179	1648	79	40	725	31	20	F16	658
55-600-66-01464	600	PN16	508	966	491	1179	1678	79	40	770	38.5	20	F16	757

The designs, materials and specifications shown are subject to change without notice due to the continuous development of our product range.