



AVK SWING CHECK VALVE, METAL SEATED

41/39

Right side free shaft, 1.4404 shaft, DN50-300, PN10/16

002

AVK series 41 swing check valves come with both metal and resilient seats. Installed in pumping applications to prevent back flow they can be used for drinking water as well as waste water. The disc is connected to the shaft via a flexible bush that allows disc and valve seat to adjust exactly. All interior parts are stainless steel or coated with drinking water approved epoxy or EPDM. The series 41 valves are available with either closed bushings or protruding shaft end where a lever with a weight or a spring can be fitted to mitigate pressure surges.

Product Description:

Metal seated swing check valve with free shaft for drinking water and neutral liquids to max. 70°C

Standards:

- Designed according to EN 1074 - 3
- Face to face according to EN 558 Table 2 Basic Series 10
- Standard flange drilling to EN1092-2 (ISO 7005-2), PN 10/16

Test/Approvals:

- Hydraulic test according to EN 1074-3.
- Seat: 1.1×PN (in bar), Body: 1.5×PN (in bar).

Features:

- Clear way and full bore for low head loss and easy pig-cleaning
- Metal seat in gunmetal bronze for high durability
- Shaft fitted in the bonnet allowing for easy maintenance without removing valve from pipeline
- Shaft, bolts and washers in 1.4404 (AISI 316L) acid resistant stainless steel
- Free protruding shaft end for mounting of lever and weight or spring to assist valve closing and avoid water hammer
- Hinge of stainless steel for sizes ≤ DN 200; ductile iron coated with drinking water approved epoxy for larger
- Ductile iron disc covered with drinking water approved EPDM
- Bonnet gasket lying in a groove between bonnet and body prevents blow-out
- All seals and coatings with contact to the fluid are approved for drinking water - coating is blue, 300µm fusion bonded epoxy
- Disc mounted in a flexible rubber bushing allowing it to tilt slightly in all directions and adjust exactly to the valve seat
- Bosses on each side of the valve seat allow for installation of pressure gauge, by-pass, etc.

Accessories:

Lever and weight, guard around lever and weight, combi-flanges, proximity switch, flange adaptors.



AVK SWING CHECK VALVE, METAL SEATED

41/39

Right side free shaft, 1.4404 shaft, DN50-300, PN10/16

002

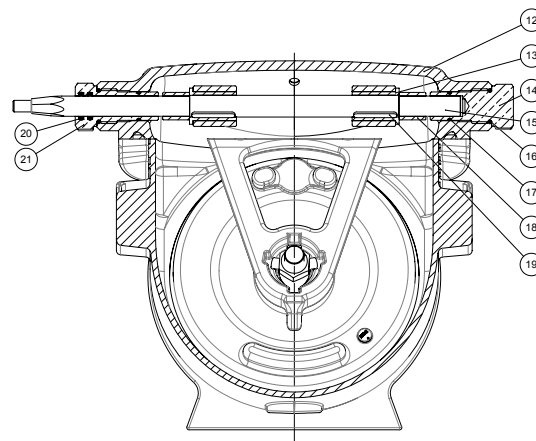
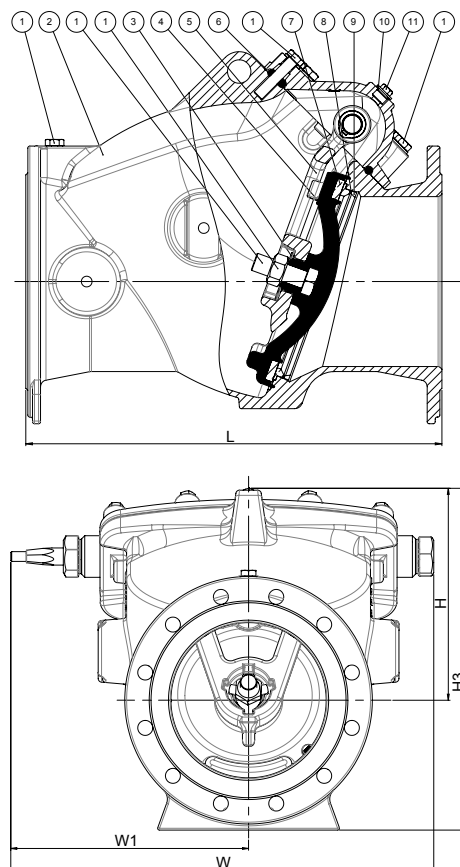

Component List:

1. Bolts and Nuts	Stainless steel A4	2. Body	Ductile iron, EN-GJS-500-7(GGG-50)
3. Washer	Stainless steel A4	4. Disc	Duct. Iron covered with EPDM
5. Hinge	DN≤200: Stainless Steel; DN≥250: Epoxy coated DI	6. Gasket	EPDM
7. Face ring	Gunmetal Bronze, CC491K	8. O-ring	NBR rubber
9. Seat ring	Gunmetal Bronze, CC491K	10. Washer	Copper
11. Air plug	Stainless Steel, 1.4404 (316)	12. Bonnet	Ductile iron, EN-GJS-500-7(GGG-50)
13. Connector	Stainless Steel, 1.4408 (316)	14. Bushing closed	Dezinc. resist. brass, CW602N
15. Shaft	Stainless Steel, 1.4404 (316)	16. O-ring	NBR rubber
17. O-ring	NBR rubber	18. Spacer	Stainless Steel, 1.4404 (316)
19. Key	Stainless Steel, 1.4404 (316)	20. O-ring	NBR rubber
21. Bushing open	Dezinc. resist. brass, CW602N		

Components may be substituted with equivalent or higher class materials without prior notification.

Reference Nos. and Dimensions:

AVK ref. nos	DN mm	Flange drilling	L mm	H mm	H3 mm	W mm	W1 mm	Theoretic. weight kg
41-050-39-0180106	50	PN10/16	203	125	210	243	148	15
41-080-39-0180106	80	PN10/16	241	140	240	238	138	16
41-100-39-0180106	100	PN10/16	292	155	265	265	165	21
41-150-39-0180106	150	PN10/16	356	220	360	333	198	38
41-200-39-0180106	200	PN16	495	250	420	388	223	66
41-250-39-0180106	250	PN16	622	347	560	692	389	132
41-300-39-0180106	300	PN16	699	395	650	695	385	210

The designs, materials and specifications shown are subject to change without notice. This is due to the continuous development of our product programme.