

Recoil Check valve, designed according to manufacturer standard, Standard flange drilling to EN1092-2 (ISO 7005-2)

Use: For water and neutral liquids to max. 70°C
Hydraulic tests: Seat: 1.1 x PN, Body: 1.5 x PN(PN25) according to EN12266-1
Applicable standards: Drilling to EN 1092-2:PN25
Options: PN16, Limit/Proximity Switch

Materials:

Body inlet & outlet	Ductile Iron EN 1563 EN-GJS-500/7
Cover, Cover stopper	Ductile Iron EN 1563 EN-GJS-500/7
Disc	Ductile Iron EN 1563 EN-GJS-500/7
Face ring, seat ring	Gunmetal EN 1982 CC491K
Hinge pin	Stainless steel EN 10088-1:(W1.4401)/ASTM A276-316
Air vent	Aluminum bronze EN 1982 CC333G
Bush	Aluminum bronze EN 1982 CW307G
Gasket	Nylon/EPDM rubber WRAS
Fasteners	Stainless steel A4-70
Coating	Internal and external blue fusion bonded epoxy(300 microns) WRAS



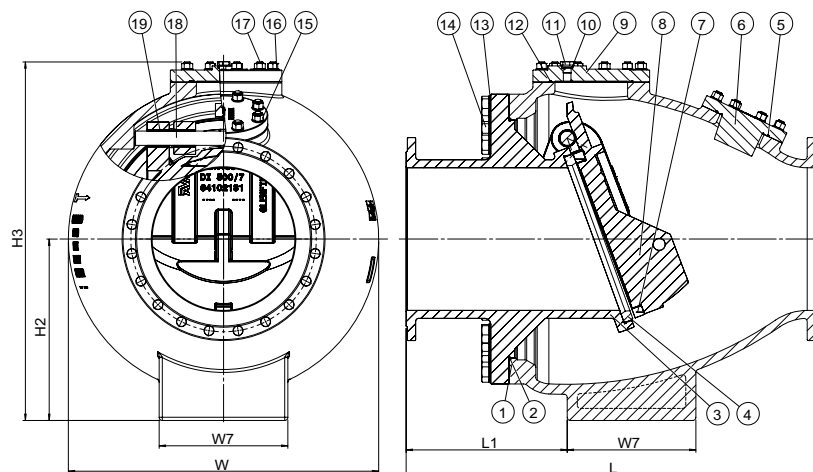

Component list

- | | |
|----------------|---------------|
| 1. Body outlet | 11. Air vent |
| 2. O-cord | 12. O-cord |
| 3. Body inlet | 13. Washer |
| 4. Seat ring | 14. Hex screw |
| 5. O-cord | 15. Nut |
| 6. Stopper | 16. Washer |
| 7. Face ring | 17. Stud |
| 8. Disc | 18. Hinge pin |
| 9. Cover | 19. Bush |
| 10. Gasket | |

Reference nos. and dimensions

AVK ref. nos.	DN mm	H2 mm	H3 mm	L mm	L1 mm	W mm	W7 mm	Theoretical weight kg
641-0350-14-701000	350	457	935	1219	469	816	305	882
641-0400-14-701000	400	457	935	1219	469	816	305	890
641-0450-14-701000	450	572	1131	1295	508	979	406	1295
641-0500-14-701000	500	660	1313	1473	546	1143	457	1986