



AVK METAL SEATED MULTI DOOR RECOIL CHECK VALVE, PN25

641/23-003

SS 1.4057 hinge pin, gunmetal seat, galv. 8.8 fastener

The recoil check valve is a high performance, fast acting, non-slam check valve used to prevent flow reversal. Mechanical assistance is given by a combination of inertia reduction, concentration of mass and ideal suspension of the moving elements. Hydraulic assistance is given by the novel provision for forward and backward water streams within the body and around the valve door.

Product description:

Multi door recoil check valve for drinking water and neutral liquids to max. 70°C

Design standards:

- Manufacturer's standard
- Flange drilling EN1092, PN25

Test/Approvals:

- Seat: 1.1 x PN. Body: 1.5 x PN.

Features:

- Fast acting closure response, it incorporates every mechanical and hydraulic assistance to aid quick valve closure
- Low reverse velocity characteristics
- Used on multi-pump systems and also single pump systems with high system deceleration gradients
- Inclined seating angle to reduce disc travel
- Integrally weight loaded door to accelerate movement
- No additional devices required to effect valve closure, it is practically maintenance free
- High reliability, it is designed based on extensive in-house laboratory research and proved by over 50 years of experience around the world
- 2-pack EP, WRAS approved, RAL5017 externally and ribbon blue or cream white internally, 250µm

Accessories:

Limit/proximity switch, by-pass



Expect... **AVR**

AVK METAL SEATED MULTI DOOR RECOIL CHECK VALVE, PN25

641/23-003

SS 1.4057 hinge pin, gunmetal seat, galv. 8.8 fastener

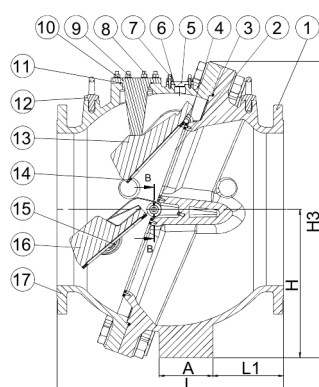
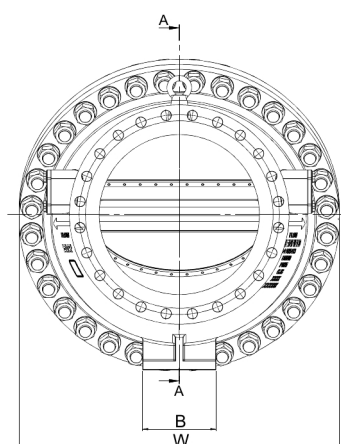

SECTION A-A DN600-800

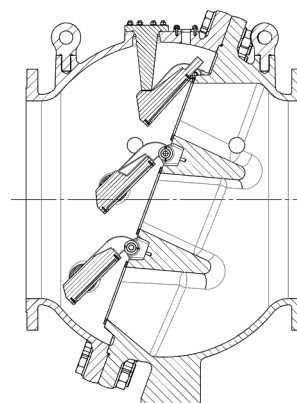

SECTION A-A DN1000-1400

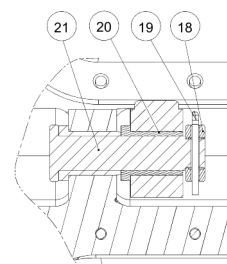
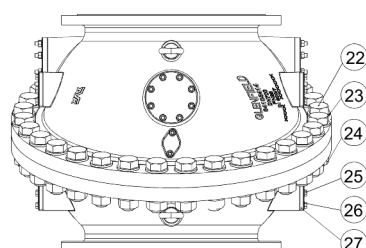

HINGE PIN ARRANGEMENT
TOP & BTM DOOR ASSY'S

SECTION B-B
SCALE 1 : 2

Component list:

1. Body inlet	Ductile iron GJS-500-7 (GGG-50)	15. Bottom stopper cover	Ductile iron GJS-500-7 (GGG-50)
2. Face ring	Bronze CC491K (RG5)	16. Bottom door	Ductile iron GJS-500-7 (GGG-50)
3. O-ring	EPDM rubber	17. Body outlet	Ductile iron GJS-500-7 (GGG-50)
4. Rivet pin	Bronze PB102	18. Hinge pin collar	Stainless steel 1.4401
5. Blind plate prox. sw.	Stainless steel 1.4401	19. Split pin	Stainless steel 1.4401
6. O-ring	EPDM rubber	20. Bush	Composite
7. Bolt	Stainless steel A4	21. Hinge pin	Stainless steel
8. Bolt	Steel, hot dip galvanized	22. Bolt	Steel, hot dip galvanized
9. Nut	Steel, hot dip galvanized	23. Washer	Stainless steel A4-70
10. Top stopper cover	Ductile iron GJS-500-7 (GGG-50)	24. Nut	Steel, hot dip galvanized
11. O-ring	EPDM rubber	25. Bolt	Steel, hot dip galvanized
12. Eye bolt (1)	Stainless steel	26. Washer	Steel, hot dip galvanized
13. Top door	Ductile iron GJS-500-7 (GGG-50)	27. Blind plate	Ductile iron GJS-500-7 (GGG-50)
14. Face ring	Bronze CC491K (RG5)		

Components may be substituted with equivalent or higher class materials without prior notification.
(1) DN600 & DN1000 & DN1400 already got lug feature, no need eye bolt.

Reference nos. and dimensions:

AVK ref. no.	DN	A	B	L	L1	H	H3	W	Theoretical weight/kg
	mm	mm	mm	mm	mm	mm	mm	mm	
641-0600-23-700000	600	250	300	990	370	670	1275	1240	1670
641-0700-23-700000	700	245	320	1030	325	680	1360	1400	2255
641-0800-23-700000	800	320	320	1040	325	780	1468	1417	2378
641-1000-23-700000	1000	360	360	1400	520	1050	2002	1975	5200
641-1200-23-700000	1200	500	500	1500	453	1160	2222	2195	7430
641-1400-23-700000	1400	500	500	1500	453	1160	2218	2195	7089

The designs, materials and specifications shown are subject to change without notice due to the continuous development of our product range.

