



AVK KNIFE GATE VALVE, PN10

702/30-103

Quick operation lever, replaceable top packing gland

AVK lug/wafer knife gate valves are bi-directional with full and plane bore. The protected sealings and high quality materials bring about a great performance and a long service life. AVK knife gate valves are available with lever, non-rising stem and handwheel, rising stem and handwheel, pneumatic actuator, ISO top flange for actuator or complete with electric actuator.

Product description:

Knife gate valve with quick operation lever for wastewater treatment 0°C to +80°C

Design standards:

- Face-to-face dimension according to DIN/EN 558-1, series 20 (K1), up to and incl. DN 350
- Flange drilling to EN1092, PN10/16

Test/Approvals:

- ISO 9001 certified - SAI Global Quality
- ISO 14001 certified - SAI Global Environment

Features:

- Replaceable top packing gland enables sealing replacement without disassembly of the valve
- The valve is self cleaning as particles will be pushed off the gate when opening the valve. For extra protection of the packing gland a scraper is available as an optional extra.
- Bi-directional, can be installed independent of the flow direction
- Full bore with no reduction of the flow
- Plane bottom prevents sediment from being accumulated
- No cavity in the body and thus no risk of clogging
- U-shaped one-piece NBR sealing between the body parts makes up for tolerances in coating and casting. It is reinforced with a steel insert to protect it from being damaged during operation.
- Encaged stem with yokes prepared for mounting of micro switches and inductive sensors
- Stem and gate connection is secured with self-locking nuts
- Supports integrated in the body casting protect the gate from deflecting under pressure
- Body of ductile iron with 100-150 µm UV resistant polyester coating, RAL 5017. Optionally of acid-resistant stainless steel or duplex
- Yokes of carbon steel with coating 100-150 µm of plascoat PPA 571 Aqua
- Gate, stem, bolts and nuts of acid-resistant stainless steel
- Washers under the bolts protect the coating
- Slim design and low weight
- Approved according to the 97/23/CE European Pressure Equipment Directive
- Approved according to the 94/9/94EC, ATEX Directive
- Optionally in higher PN class



Expect... **AVR**



The designs, materials and specifications shown are subject to change without notice due to the continuous development of our product range.

AVK KNIFE GATE VALVE, PN10

Quick operation lever, replaceable top packing gland

702/30-103

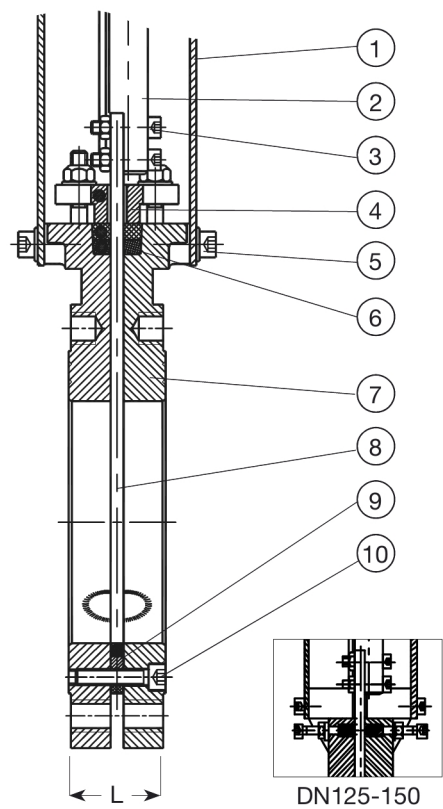
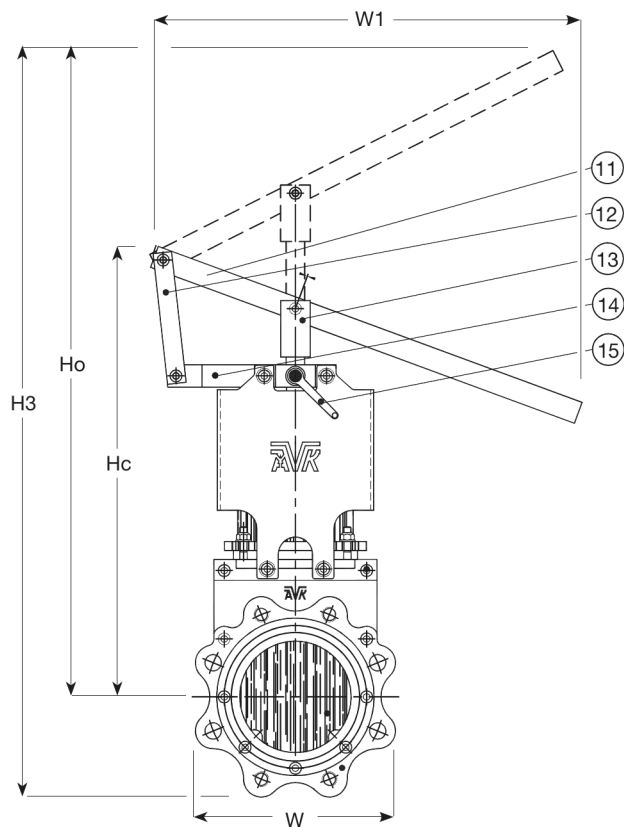

Component list:

1. Plate	Carbon steel	9. U-shaped seal	Steel / NBR
2. Stem	Stainless steel AISI 316	10. Bolt	Stainless steel A4
3. Bolt/nut	Stainless steel A4	11. Lever	Carbon steel
4. Top packing gland	Ductile iron GJS-400-15	12. Guide	Carbon steel
5. Bolt	Stainless steel A4	13. Drag link	Carbon steel
6. Packing	NBR + PTFE	14. Lever bracket	Carbon steel
7. Body	Ductile iron GJS-400-15	15. Lock	Steel
8. Gate	Stainless steel AISI 316		

Components may be substituted with equivalent or higher class materials without prior notification.

Reference nos. and dimensions:

AVK ref. no.	DN mm	Flange drilling	L mm	H3 mm	W mm	W1 mm	H closed mm	H open mm	Test pressure bar	Work press. bar	Theoretical weight/kg
702-050-30-134	50	PN10/16	43	657	130	402	363	592	10	5	9.5
702-065-30-134	65	PN10/16	46	792	143	503	395	720	10	5	12
702-080-30-134	80	PN10/16	46	850	183	601	431	758	10	5	17
702-100-30-134	100	PN10/16	52	933	202	703	475	831	10	5	20
702-125-30-134 ⁽¹⁾	125	PN10/16	56	1028	229	804	528	913	10	5	23
702-150-30-134 ⁽¹⁾	150	PN10/16	56	1297	267	1003	670	1162	10	2	36

(1) Without a replaceable top packing gland