



## AVK DOUBLE ECCENTRIC BUTTERFLY VALVE, PN10/16

### Integral seat, IP67 gearbox, plate disc, long

756/100-104

AVK double eccentric butterfly valves are designed with tilted and fixated disc for extended service life and easy operation. The disc seal is made of AVK's drinking water approved EPDM rubber featuring an excellent compression set and thus ability to regain its original shape. The GSK approved epoxy coating and the corrosion protected shaft end zones ensure high durability. The valves are suitable for bi-directional application.

#### Product description:

Double eccentric butterfly valve to EN 593 w. integral seat and IP67 gearbox w. handwheel and position indicator. For drinking water and neutral liquids to max. 70°C

#### Standards:

- Designed according to EN 593
- Face-to-face dimension according to EN 558 Table 2 Basic Series 14
- Standard flange drilling to EN1092-2 (ISO 7005-2), PN 10/16

#### Test/Approvals:

- Hydraulic test according to EN 1074-1 and 2 / EN 12266
- Approved according to DIN-DVGW Certificate NW-6201BR0451
- Approved according to KIWA Certificate K 6320
- Approved according to WRAS Certificate No. 1702367

#### Features:

- The tilted disc releases the compression of the disc sealing after a few degrees of opening, which extends the durability and gives low operating torques
- The disc is fixated to prevent wear and fluttering
- The disc seal profile and rubber quality ensure low closing torques
- All rubber parts are multi approved
- Seal retainer ring of stainless steel
- The threaded bolt holes in the disc are corrosion protected with O-rings
- Machined and epoxy coated ductile iron seat integrated in the body
- Shaft of stainless steel with self-lubricating bearings
- The shaft ends are corrosion protected with a stainless steel security plate and a gasket
- Replaceable shaft sealing with an EPDM O-ring on a stainless steel ring, a back-up EPDM O-ring in the housing, and a flat NBR gasket
- Optional locking device
- Body and disc of ductile iron with fusion bonded epoxy coating to DIN 3476-1 and EN 14901, GSK approved, RAL 5017

#### Accessories:

Locking device, extension spindle, street cover, handwheel, stem cap for rod #25 mm, adaptor gearside, dismantling joint and flange adaptor



**kiwa**

Expect... **AVK**

The designs, materials and specifications shown are subject to change without notice due to the continuous development of our product range.

COPYRIGHT©AVK GROUP 2020

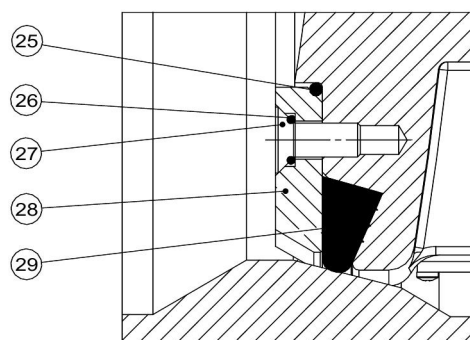
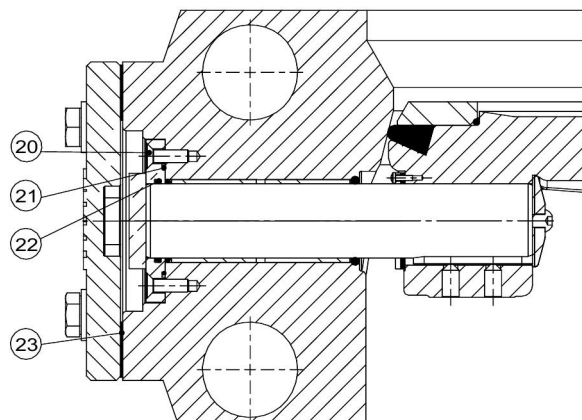
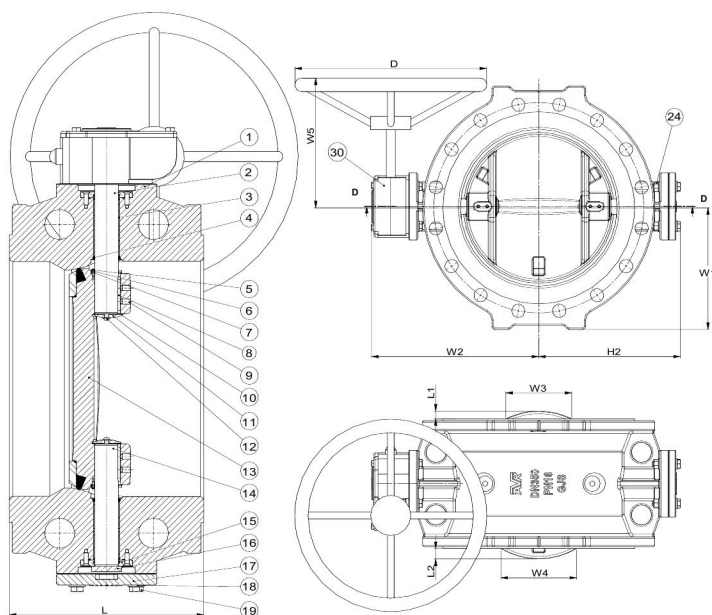
**AVK DOUBLE ECCENTRIC BUTTERFLY VALVE, PN10/16****756/100-104****Integral seat, IP67 gearbox, plate disc, long****Component list:**

1. Body	Ductile iron GJS-500-7 (GGG-50)	16. Thrust bearing	Bronze
2. Shaft, drive	Stainless steel 431	17. End plate	Ductile iron GJS-500-7 (GGG-50)
3. Bearing	Steel, PTFE coated	18. Washer	Stainless steel A2
4. O-ring	EPDM rubber	19. Bolt	Stainless steel A2
5. Bolt, socket head	Stainless steel A2	20. Screw	Stainless steel A2
6. Cover	Stainless steel	21. O-ring	EPDM rubber
7. Gasket	EPDM rubber	22. O-ring	EPDM rubber
8. Key	Stainless steel A2	23. Gasket	EPDM rubber
9. Set screw	Stainless steel A2	24. Nut	Stainless steel A2
10. Gasket	EPDM rubber	25. O-ring	EPDM rubber
11. End cover	Stainless steel	26. O-ring	EPDM rubber
12. Screw	Stainless steel A2	27. Screw	Stainless steel A2
13. Disc	Ductile iron GJS-500-7 (GGG-50)	28. Seal retainer ring	Stainless steel
14. Shaft, stub	Stainless steel 431	29. Seal ring	EPDM rubber
15. Spacer	Bronze	30. Gearbox	Cast iron

Components may be substituted with equivalent or higher class materials without prior notification.

**Reference nos. and dimensions:**

AVK ref. no.	DN	Flange	D	L	L1	L2	H2	W1	W2	W3	W4	W5	Theoretical weight/kg
	mm	drilling	mm	mm	mm	mm	mm	mm	mm	mm	mm	mm	
756-0150-1-14	150	PN10/16	250	210	-	-	201	155	263	-	-	276	38
756-0200-1-04	200	PN10	250	230	-	-	227	182	279	-	-	276	51
756-0200-1-14	200	PN16	250	230	-	-	227	182	279	-	-	276	51
756-0250-1-04	250	PN10	250	250	-	1	261	215	313	-	6	276	71
756-0250-1-14	250	PN16	250	250	-	1	261	215	313	-	6	276	71
756-0300-1-04	300	PN10	400	270	1	12	292	242	343	6	104	306	100
756-0300-1-14	300	PN16	400	270	1	12	292	242	343	6	104	306	106
756-0350-1-04	350	PN10	400	290	20	26	318	272	369	151	173	306	128
756-0350-1-14	350	PN16	400	290	20	26	318	272	369	151	173	306	134

The designs, materials and specifications shown are subject to change without notice due to the continuous development of our product range.

**AVK DOUBLE ECCENTRIC BUTTERFLY VALVE, PN10/16****756/100-104****Integral seat, IP67 gearbox, plate disc, long****Reference nos. and dimensions:**

AVK ref. no.	DN	Flange	D	L	L1	L2	H2	W1	W2	W3	W4	W5	Theoretical
	mm	drilling	mm	mm	mm	mm	mm	mm	mm	mm	mm	mm	weight/kg
756-0400-1-04	400	PN10	400	310	35	41	349	302	403	215	232	306	166
756-0400-1-14	400	PN16	400	310	35	41	349	302	403	215	232	306	166
756-0450-1-04	450	PN10	500	330	48	55	390	332	440	267	284	416	211
756-0450-1-14	450	PN16	500	330	48	55	390	332	440	267	284	416	219
756-0500-1-04	500	PN10	500	350	63	69	427	370	477	322	335	416	206
756-0500-1-14	500	PN16	500	350	63	69	427	370	477	322	335	416	282
756-0600-1-04	600	PN10	600	390	94	100	503	435	556	426	437	456	285
756-0600-1-14	600	PN16	600	390	94	100	503	435	556	426	437	456	426