



AVK DOUBLE ECCENTRIC BUTTERFLY VALVE, PN10/16

756/106-146

Integral seat, IP68 gearbox, plate disc, long

AVK double eccentric butterfly valves are designed with tilted and fixated disc for extended service life and easy operation. The disc seal is made of AVK's drinking water approved EPDM rubber featuring an excellent compression set and thus ability to regain its original shape. The GSK approved epoxy coating and the corrosion protected shaft end zones ensure high durability. The valves are suitable for bi-directional application.

Product description:

Double eccentric butterfly valve to EN 593 w. integral seat and IP68 gearbox for drinking water and neutral liquids to max. 70°C

Standards:

- Designed according to BS, Designed according to EN 593
- Face-to-face dimension according to EN 558 Table 2 Basic Series 14
- Standard flange drilling to EN1092-2 (ISO 7005-2), PN 10/16

Test/Approvals:

- Hydraulic test according to EN 1074-1 and 2 / EN 12266
- Approved according to DIN-DVGW Certificate NW-6201BR0451
- Approved according to KIWA Certificate K 6320
- Approved according to WRAS Certificate No. 1702367

Features:

- The tilted disc releases the compression of the disc sealing after a few degrees of opening, which extends the durability and gives low operating torques
- The disc is fixated to prevent wear and fluttering
- The disc seal profile and rubber quality ensure low closing torques
- All rubber parts are multi approved
- Seal retainer ring of epoxy coated steel
- The threaded bolt holes in the disc are corrosion protected with O-rings
- Machined and epoxy coated ductile iron seat integrated in the body
- Shaft of stainless steel with self-lubricating bearings
- The shaft ends are corrosion protected with a stainless steel security plate and a gasket
- Replaceable shaft sealing with an EPDM O-ring on a stainless steel ring, a back-up EPDM O-ring in the housing, and a flat NBR gasket
- Optional locking device
- Body and disc of ductile iron with fusion bonded epoxy coating in compliance with DIN 3476 part 1 and EN 14901, GSK approved

Accessories:

Locking device, extension spindle, street cover, handwheel, stem cap for rod #25 mm, adaptor gearside, dismantling joint and flange adaptor

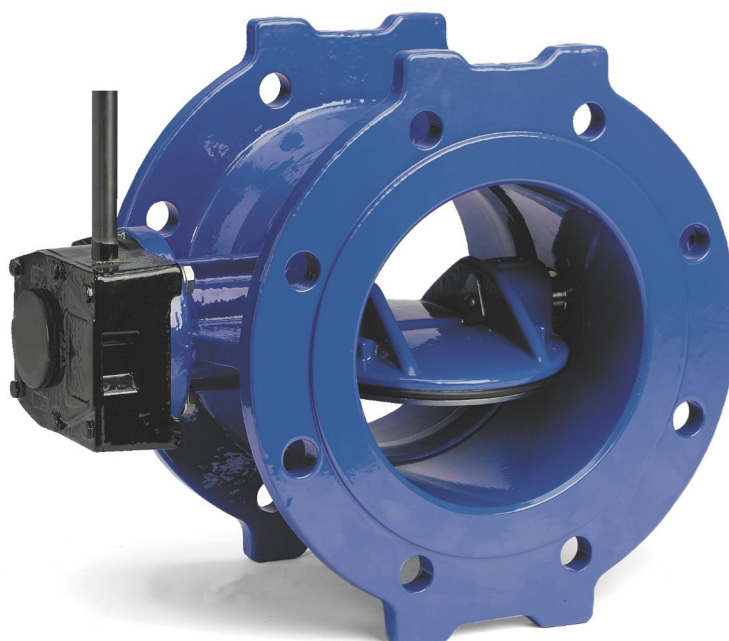

kiwa

Expect... **AVK**

The designs, materials and specifications shown are subject to change without notice due to the continuous development of our product range.

COPYRIGHT©AVK GROUP 2020

AVK DOUBLE ECCENTRIC BUTTERFLY VALVE, PN10/16

Integral seat, IP68 gearbox, plate disc, long

756/106-146

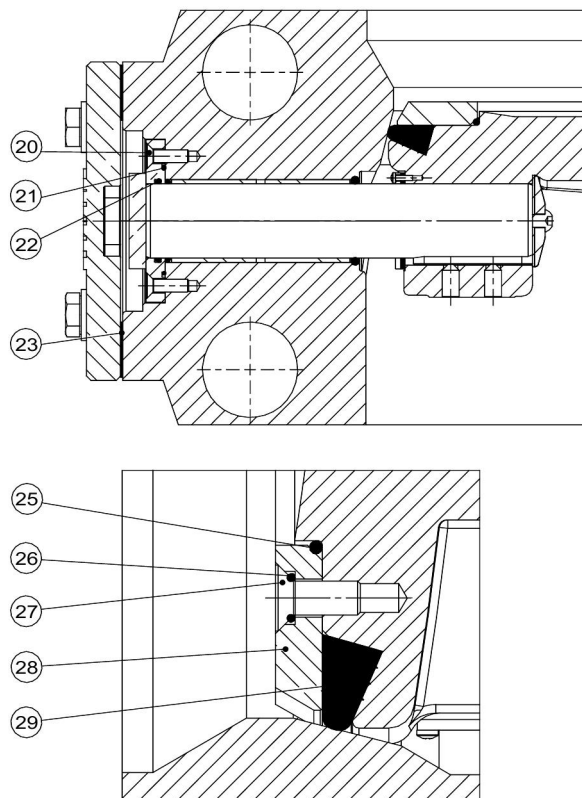
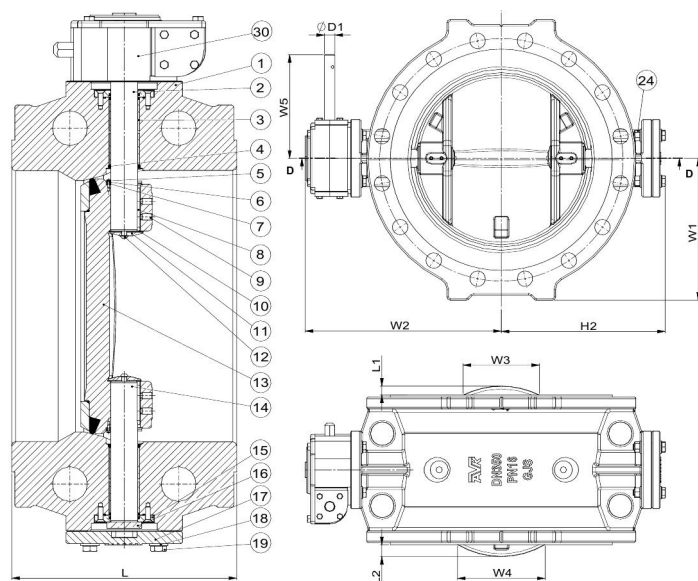

Component list:

1. Body	Ductile iron GJS-500-7 (GGG-50)	16. Thrust bearing	Bronze
2. Shaft, drive	Stainless steel 431	17. End plate	Ductile iron GJS-500-7 (GGG-50)
3. Bearing	Steel, PTFE coated	18. Washer	Stainless steel A2
4. O-ring	EPDM rubber	19. Bolt	Stainless steel A2
5. Bolt, socket head	Stainless steel A2	20. Screw	Stainless steel A2
6. Cover	Stainless steel	21. O-ring	EPDM rubber
7. Gasket	EPDM rubber	22. O-ring	EPDM rubber
8. Key	Stainless steel A2	23. Gasket	EPDM rubber
9. Set screw	Stainless steel A2	24. Nut	Stainless steel A2
10. Gasket	EPDM rubber	25. O-ring	EPDM rubber
11. End cover	Stainless steel	26. O-ring	EPDM rubber
12. Screw	Stainless steel A2	27. Screw	Stainless steel A2
13. Disc	Ductile iron GJS-500-7 (GGG-50)	28. Seal retainer ring	Stainless steel
14. Shaft, stub	Stainless steel 431	29. Seal ring	EPDM rubber
15. Spacer	Bronze	30. Gearbox	Cast iron

Components may be substituted with equivalent or higher class materials without prior notification.

Reference nos. and dimensions:

AVK ref. no.	DN	Flange	D1	L	L1	L2	H2	W1	W2	W3	W4	W5	Theoretical weight/kg
	mm	drilling	mm	mm	mm	mm	mm	mm	mm	mm	mm	mm	
756-0150-1-14006	150	PN10/16	20	210	-	-	201	155	261	-	-	178	37
756-0200-1-04006	200	PN10	20	230	-	-	227	182	279	-	-	178	40
756-0200-1-14006	200	PN16	20	230	-	-	227	182	279	-	-	178	51
756-0250-1-04006	250	PN10	20	250	-	1	261	215	313	-	6	178	58
756-0250-1-14006	250	PN16	20	250	-	1	261	215	313	-	6	178	50
756-0300-1-04006	300	PN10	20	270	1	12	292	242	343	6	104	178	83
756-0300-1-14006	300	PN16	20	270	1	12	292	242	343	6	104	189	106
756-0350-1-04006	350	PN10	20	290	20	26	318	272	369	151	173	178	110
756-0350-1-14006	350	PN16	20	290	20	26	318	272	369	151	173	189	172

The designs, materials and specifications shown are subject to change without notice due to the continuous development of our product range.

AVK DOUBLE ECCENTRIC BUTTERFLY VALVE, PN10/16**756/106-146****Integral seat, IP68 gearbox, plate disc, long****Reference nos. and dimensions:**

AVK ref. no.	DN	Flange	D1	L	L1	L2	H2	W1	W2	W3	W4	W5	Theoretical
	mm	drilling	mm	mm	mm	mm	mm	mm	mm	mm	mm	mm	weight/kg
756-0400-1-04006	400	PN10	20	310	35	41	349	302	403	215	232	189	142
756-0400-1-14006	400	PN16	20	310	35	41	349	302	403	215	232	189	166
756-0450-1-04006	450	PN10	20	330	48	55	390	332	440	267	284	189	184
756-0450-1-14006	450	PN16	20	330	48	55	390	332	440	267	284	205	214
756-0500-1-04006	500	PN10	20	350	63	69	418	338	468	322	335	189	240
756-0500-1-14006	500	PN16	20	350	63	69	427	370	477	322	335	205	214
756-0600-1-04006	600	PN10	20	390	94	100	481	393	536	426	437	205	410
756-0600-1-14006	600	PN16	20	390	94	100	503	435	556	426	437	284	425