



## AVK DOUBLE ECC. BUTTERFLY VALVE, LONG, PN10/16

IP67 gearbox w. handwheel/pos. ind., SS-shaft, intgr. seat, A2 fasteners

756/118-005

AVK double eccentric butterfly valves with tilted disc are designed for easy operation and long service life. The disc seal is made of AVK's drinking water approved EPDM rubber featuring an excellent compression set and ability to regain the original shape. The high quality epoxy coating and fully encapsulated shaft/disc connection ensure optimal corrosion protection and durability

### Product description:

Double eccentric butterfly valve to EN 593 for neutral liquids like drinking water and treated waste water free from solids and fibrous impurities to max 70°C.

### Design standards:

- EN 593
- Face-to-face dimension according to EN 558 Table 2 Basic Series 14
- Flange drilling to EN1092, PN10/16

### Test/Approvals:

- Hydraulic test according to EN 1074-1 and 2 / EN 12266
- Approved according to KIWA Certificate K 6320
- Approved for drinking water according to WRAS Certificate No. 2206003
- Approved according to DIN-DVGW Certificate NW-6201BR0451

### Features:

- Double eccentric design releases seal compression after only few degrees of opening resulting in low operating torque
- Disc firmly fixed to the shaft to prevent fluttering and a slight tilt allows for precise adjustment of the closed position
- Disc seal profile and rubber quality ensure low closing torque
- All rubber parts drinking water approved by multiple institutes
- Fasteners in stainless steel, A2
- Stainless steel shaft
- Machined and epoxy coated ductile iron seat integrated in the body
- All threaded connections are sealed with O-rings for protection against medium and environment
- Radial bearings in self-lubricating PTFE/bronze composite
- Shaft ends fitted with an end cover that keeps the shaft in position against system pressure and seals the disc interior against corrosion
- Replaceable shaft seals with two EPDM O-rings; gaskets to the exterior in hydrocarbon resistant NBR
- Coated with blue RAL 5017 FBE to DIN 3476, GSK and approved by WRAS-DVGW/W270/UBA, 250µm

### Accessories:

Extension spindle, street cover, handwheel, stem cap for rod #25 mm, adaptor gearside, dismantling joint, flange adaptor



**kiwa**

Expect... **AVK**

The designs, materials and specifications shown are subject to change without notice due to the continuous development of our product range.

**AVK DOUBLE ECC. BUTTERFLY VALVE, LONG, PN10/16**  
**IP67 gearbox w. handwheel/pos. ind., SS-shaft, intgr. seat, A2 fasteners**

**756/118-005**

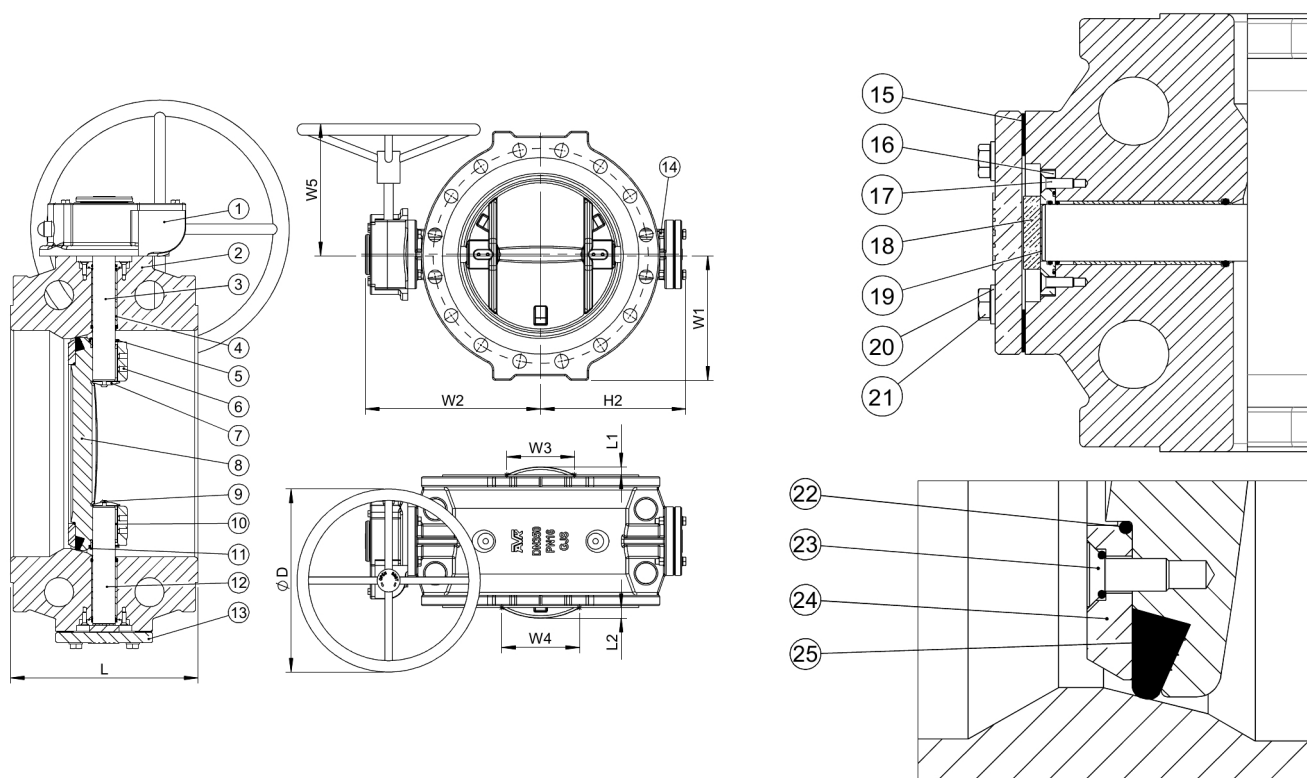

**Component list:**

1. Gearbox	Cast iron	14. Nut	Stainless steel A2
2. Body	Ductile iron GJS-500-7 (GGG-50)	15. Gasket	EPDM rubber
3. Shaft, drive	Stainless steel AISI 420	16. Spacer	Bronze
4. Bearing	Bronze/PTFE composite	17. Screw	Stainless steel A2
5. Cover	Stainless steel	18. Thrust bearing	Bronze
6. Set screw	Stainless steel A2	19. Screw	Stainless steel A2
7. End cover	Stainless steel	20. Washer	Stainless steel A2
8. Disc	Ductile iron GJS-500-7 (GGG-50)	21. Bolt	Stainless steel A2
9. Screw	Stainless steel A2	22. O-ring	EPDM rubber
10. Key	Stainless steel A2	23. Screw	Stainless steel A2
11. Screw	Stainless steel A2	24. Seal retainer ring	Steel
12. Shaft, stub	Stainless steel AISI 420	25. Seal ring	EPDM rubber
13. End plate	Ductile iron GJS-500-7 (GGG-50)		

Components may be substituted with equivalent or higher class materials without prior notification.

**Reference nos. and dimensions:**

AVK ref. no.	DN	Flange	D	L	L1	L2	H2	W1	W2	W3	W4	W5	Theoretical weight/kg
	mm	drilling	mm	mm	mm	mm	mm	mm	mm	mm	mm	mm	
756-0150-1-14018014	150	PN16	250	210	-	-	201	155	263	-	-	276	38
756-0200-1-04018014	200	PN10	250	230	-	-	227	182	279	-	-	276	51
756-0200-1-14018014	200	PN16	250	230	-	-	227	182	279	-	-	276	51
756-0250-1-04018014	250	PN10	250	250	-	1	261	215	313	-	6	276	71
756-0250-1-14018014	250	PN16	250	250	-	1	261	215	313	-	6	276	71
756-0300-1-04018014	300	PN10	250	270	1	12	292	242	343	6	104	276	100
756-0300-1-14018014	300	PN16	400	270	1	12	292	242	346	6	104	306	106
756-0350-1-04018014	350	PN10	250	290	20	26	318	272	369	151	173	276	128
756-0350-1-14018014	350	PN16	400	290	20	26	318	272	372	151	173	306	134
756-0400-1-04018014	400	PN10	400	310	35	41	349	302	403	215	232	306	166
756-0400-1-14018014	400	PN16	400	310	35	41	349	302	403	215	232	306	166

The designs, materials and specifications shown are subject to change without notice due to the continuous development of our product range.

**AVK DOUBLE ECC. BUTTERFLY VALVE, LONG, PN10/16**  
**IP67 gearbox w. handwheel/pos. ind., SS-shaft, intgr. seat, A2 fasteners**

**756/118-005**

**Reference nos. and dimensions:**

AVK ref. no.	DN	Flange	D	L	L1	L2	H2	W1	W2	W3	W4	W5	Theoretical weight/kg
	mm	drilling	mm	mm	mm	mm	mm	mm	mm	mm	mm	mm	
756-0450-1-04018014	450	PN10	400	330	48	55	390	332	440	267	284	306	211
756-0450-1-14018014	450	PN16	500	330	48	55	390	332	449	267	284	416	219
756-0500-1-04018014	500	PN10	400	350	63	69	418	338	468	322	335	306	206
756-0500-1-14018014	500	PN16	500	350	63	69	427	370	477	322	335	416	282
756-0600-1-04018014	600	PN10	500	390	94	100	481	393	536	426	437	416	285
756-0600-1-14018014	600	PN16	600	390	94	100	503	435	556	426	437	456	426